

Safe for Monarchs Sunny Front Garden

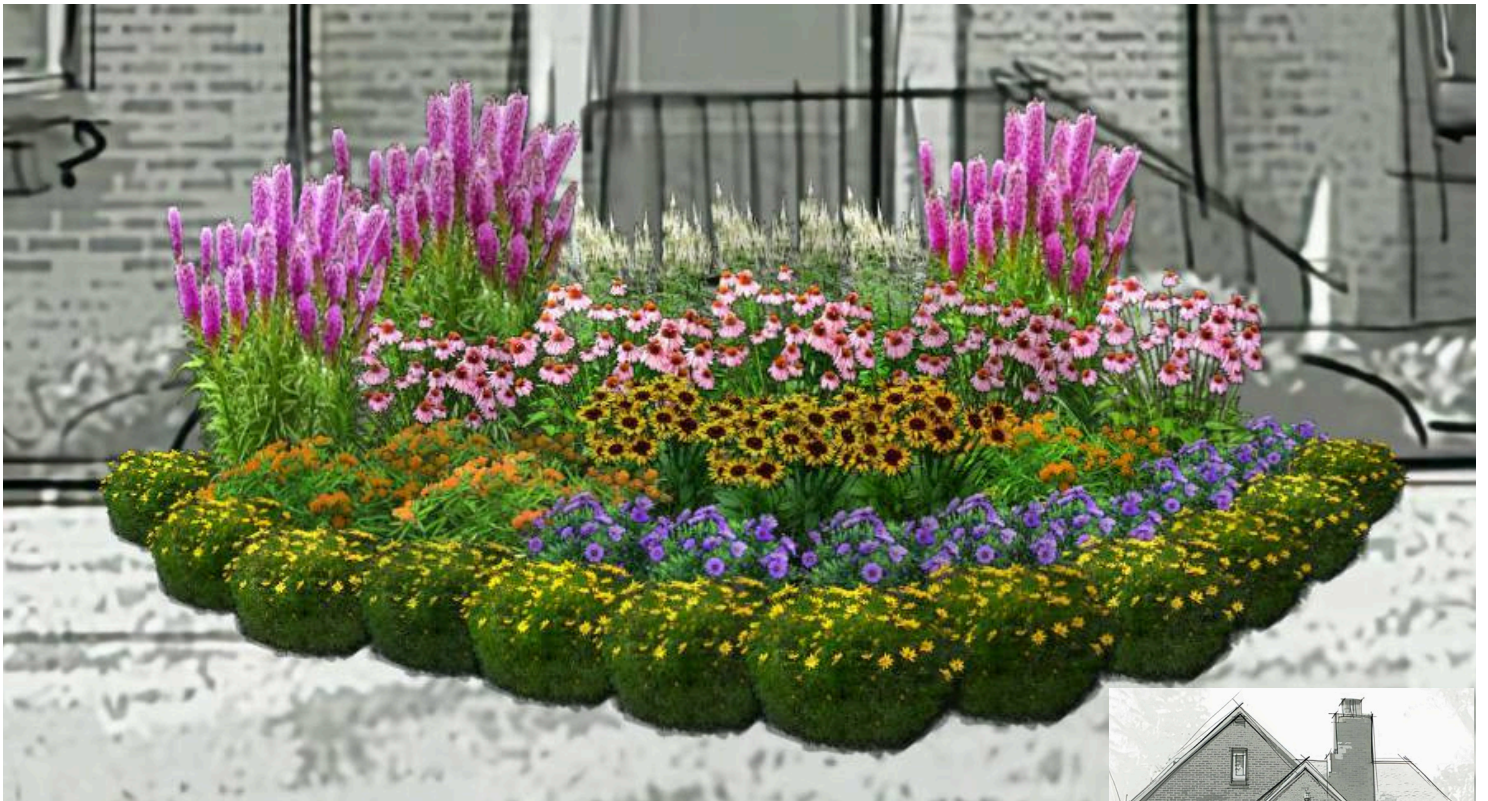

*Growing Conditions:
Full sun,
Medium to medium-dry moisture*

Safe for Monarchs

Sunny Front Garden Plant List



4 Butterflyweed
Asclepias tuberosa
Height: 2 ft
Sun: Full, partial
Soil: Med-dry to Dry
Bloom Period: Jun-Aug



7 Sky-blue Aster
Symphyotrichum oolentangiense
Height: 3 ft
Sun: Full, partial
Soil: Med to Dry
Bloom Period: Aug-Oct



16 Lanceleaf Coreopsis
Coreopsis lanceolata
Height: 2 ft
Sun: Full
Soil: Med-dry to Dry
Bloom Period: May-Aug



3 Meadow Blazing Star
Liatris ligulistylis
Height: 5 ft
Sun: Full, partial
Soil: Med-wet to med-dry
Bloom Period: Aug-Sep



5 Purple Coneflower
Echinacea purpurea
Height: 4 ft
Sun: Full, partial
Soil: Med-wet to Med-dry
Bloom Period: Jul-Sep
Substitute: Pale purple coneflower in dryer conditions



3 Orange Coneflower
Rudbeckia fulgida
Height: 3 ft
Sun: Full, partial
Soil: Med-wet to Med-dry
Bloom Period: Jul-Sep



3 Culver's Root
Veronicastrum virginicum
Height: 5 ft
Sun: Full, partial
Soil: Med-wet to Med-dry
Bloom Period: Jun-Aug

Key Safe for Monarch Garden Characteristics

- Plants bloom from May-Oct (the entire monarch season in Wisconsin).
- All plants are Safe for Monarch list plants.
- If you get them from Safe for Monarch nurseries, none are grown with toxic chemicals for monarchs.



Look for these and more at one of these Safe for Monarchs nurseries:
wimonarchs.org/safe